

INSTRUCTIONS FOR STOOL COLLECTION



Solutions in kit are poisonous - Keep out of reach of children - Do not drink

Please read and follow all instructions below. Following the instructions will help the laboratory do a better job and avoid costly repeat testing. Call 268-6333, extension 7521 if you have any questions.

DO NOT

- urinate on the specimen or in the specimen collection container
- urinate in the tubes
- pass the specimen directly into the tube
- pass the specimen into a toilet

The kit consists of 3 tubes. The black and yellow capped container both has liquid in them. The white tube has no liquid.



The stool should be passed into a clean, dry container. Use a bed- pan, clean margarine tub, large wide-mouthed jar, or a clean milk carton with the top cut off.

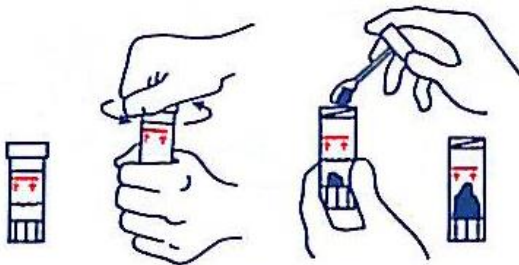

Open one of the tubes containing the liquid. Using the collection spoon built into the tube, or a disposable plastic spoon, place small scoops of stool from areas that appear slimy, bloody or watery into the tube until the contents rise to the **red** line. **Do not** fill the tube all the way to the top.



Mix the contents of the tube with the spoon, and then twist the cap tightly closed and shake vigorously until the contents are well mixed.

Repeat above steps for the remaining liquid filled tube.

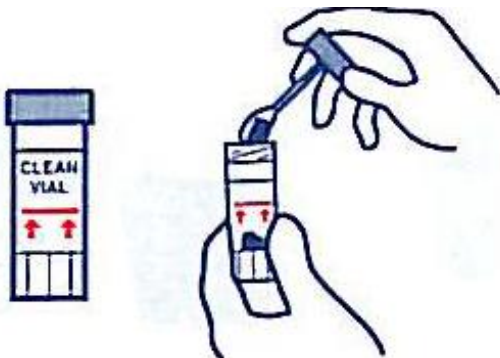

The tube with no liquid in it should be filled to the red line as above. **Do not** mix or shake this tube.

Continued on back



**CHECK ALL CAPS TO
MAKE SURE THEY ARE
TIGHTLY CLOSED.**

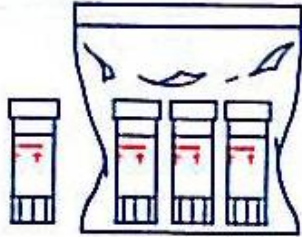

Mark the labels on the tubes with the identification information requested. Also, check the box on the label that looks most like the specimen when collected.

All tubes may be stored in a plastic bag in the refrigerator until transported to the laboratory. Tubes may be stored for up to 24 hours.

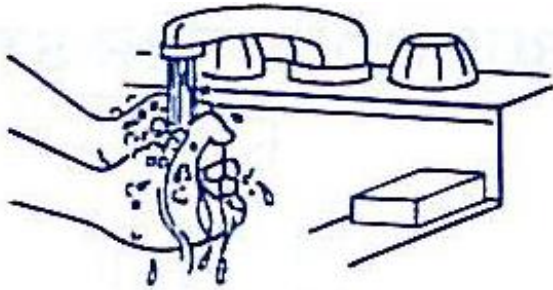

Wash your hands thoroughly. If any liquid from the tubes gets on your skin or in your eyes, flush with plenty of running water. If irritation develops, consult a physician.

- **Return the collection kit to your physician or laboratory within 24 hours.**
- **Refrigerate until delivery of kit.**

ANTIDOTE IF SWALLOWED: Dilute by drinking 2-4 glasses of water. Immediately contact an emergency facility, poison information center, or a physician to receive medical attention. Save the reagent vial; label information will be helpful for determining appropriate medical treatment.

Collection Locations and Times-Closed Weekends and Holidays

Parrish Medical Center (Express Testing) - 951 N. Washington Ave - Titusville, FL 32796 –
Phone: 321-268-6134, Monday-Friday- 6:30am - 6:00pm

Parrish Health & Fitness - 2210 Hwy 50 - Titusville, FL 32780 - Phone: 321-268-6333 - (ext 8598)
Monday- Thursday 6:30am – 2:45pm & Friday 6:30am – 1:00pm

Parrish Healthcare Center -5005 Port St John Pkwy -Port St. John, FL 32927- Phone: 321-636-9393
Monday-Friday -7:00am - 2:45pm (**Closed Noon – 12:30**)

Parrish Medical Group Diagnostics Center

3045 Columbia Blvd, Unit 108A Titusville, Florida 32780 - Phone: 321-268-6821
Monday–Friday - 7:00 am–7:00 pm